

CF-AN PAT.

Specifications for Storable Bicycle

Load Weight	Tire Diameter	Tire Width	Body Length	Handle Width	Rack Pitch	Save Space
Less than 20kg	20~28inch	Less than 55mm	Less than 1820mm	Less than 600mm	400mm	Save Space

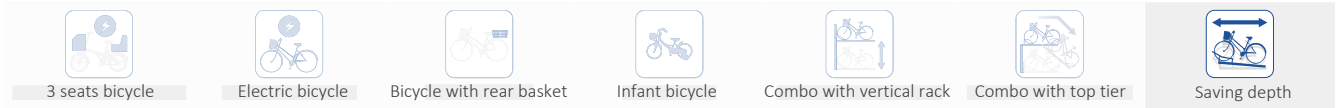

Space-Saving Bicycle Hanging Storage

Easy operation by just hanging front wheel



CF-AN

Model	Unit Price
CF-AN	¥61,000

Features



- **Save Space**
Save space by vertical hanging
- **Fordable Arm**
Fordable Arm doesn't take up space when not in use
- **Angle Adjust**
Rack body itself swings left and right



- **Safety Design**
Equipped with safety lock to prevent arm bounce. Automatically locks when lowering the arm.
- **Chain Lock with Bracket**
Equipped with bracket that allows for chain lock to be threaded through
*Dia hole Φ30
(Not equipped with chain lock)

- **Easy Operation**
Easy to raise and lower with equipped gas damper

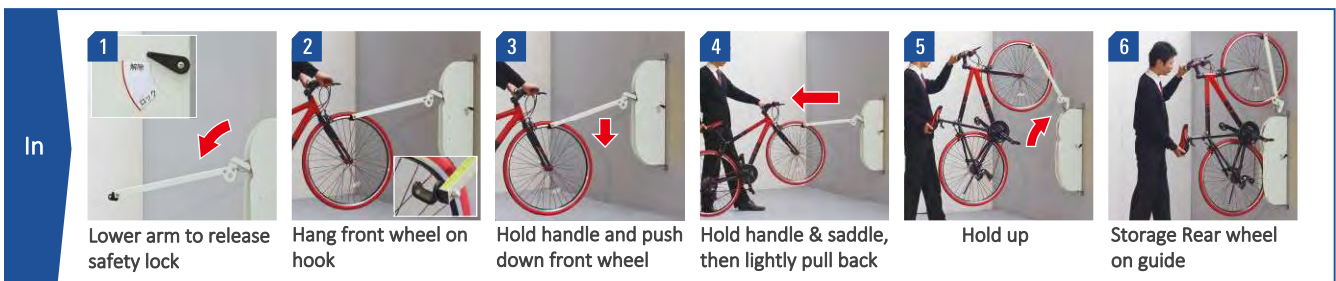

In

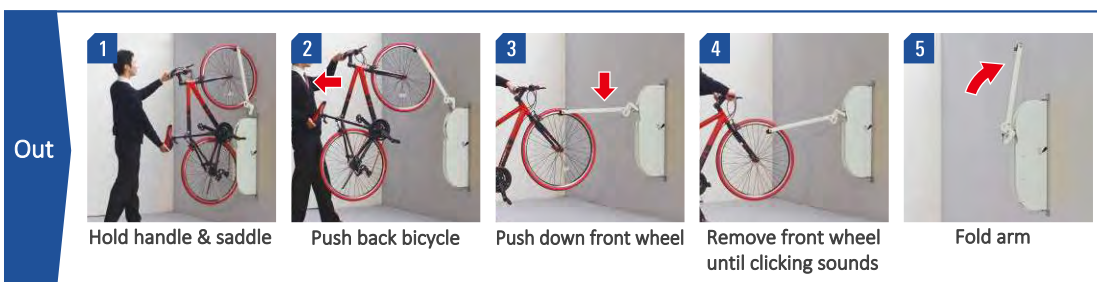

Out

▶
Movie

CF-AN

*If wall mounted, prepare for anchor separately(M8 x 50 2pcs/1 unit)

*Minimum Wall thickness: 150mm or more

*If there is ceiling, height at least 2200mm is required *Width distance at least 2500mm from wall is required

Installed in the floor level where the cross direction slope is less than 1% and front-back direction slope is 1%.

Plan View

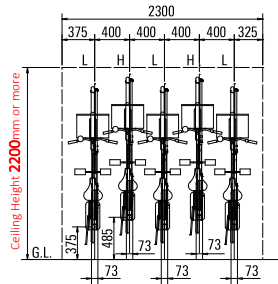

Side View (For low position)

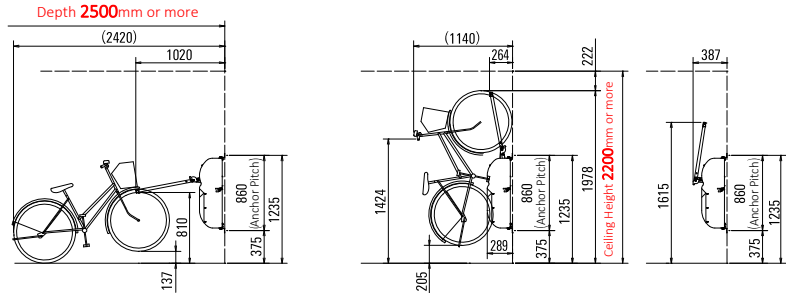

Both Sides Installation

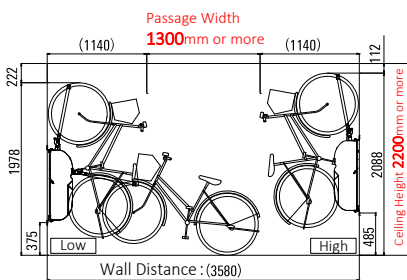

Side View (For High position)

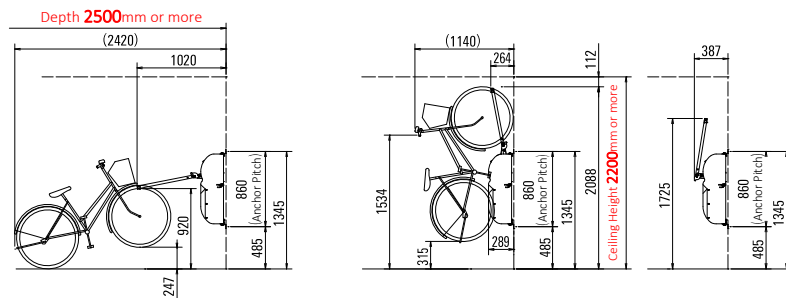

Parts Name	Dimension	Material	Color
Cover	26×262×800	hot-dip galvanizing	Gray
Arm Body	20×30×330	electro-galvanized steel pipe	Gray

*Anchor bolt is separated

Installation Reference

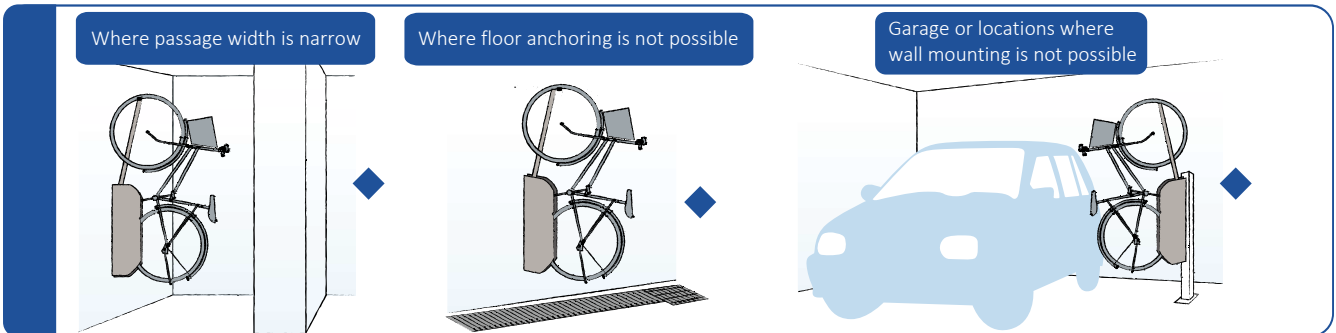

Option

Rack Number Seal

5

1 digit(V28xW17mm)
10digits(V28xW30mm)
100digits(V28xW45mm)

*Confirm price with supplier

Self-stand Pole (*Made to order)

Self floor mounted for site
where wall mounted is not possible

High : CF-A PH
Low : CF-A PL

¥24,000/set

- Steel material
- Color: Gray
- Anchor bolt(M12 x 70)
- With mount screws

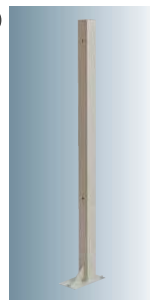

Site Reference



Note

- Reinforced Concrete (RC) use only. Not suitable for ALC and wooden base mount.
- Do not install in places without roofs or where the wind is strong.
- Child seats, electric-assist bicycles, and special bicycles may not be storable.
- Be sure to lock the bicycle for theft prevention.
- Do not store with luggage stacked.
- Do not remove your hand from the bicycle while in operation.
- Please be careful not to let small children use this product.
- Do not lower arm when safety lock is engaged, as it may cause malfunction.

- Storage may not be possible depending on the size and shape of the bicycle.
- Don't storage bicycle over 20kg